



**Hansagreen**  
LED

## **ARC NEXA DC**

ARCND-PTS-80W-XXXXK



+971 65 260 706

| [sales-me@hansagreen.com](mailto:sales-me@hansagreen.com)

| [www.hansagreen.com](http://www.hansagreen.com)



## PRODUCT HIGHLIGHTS

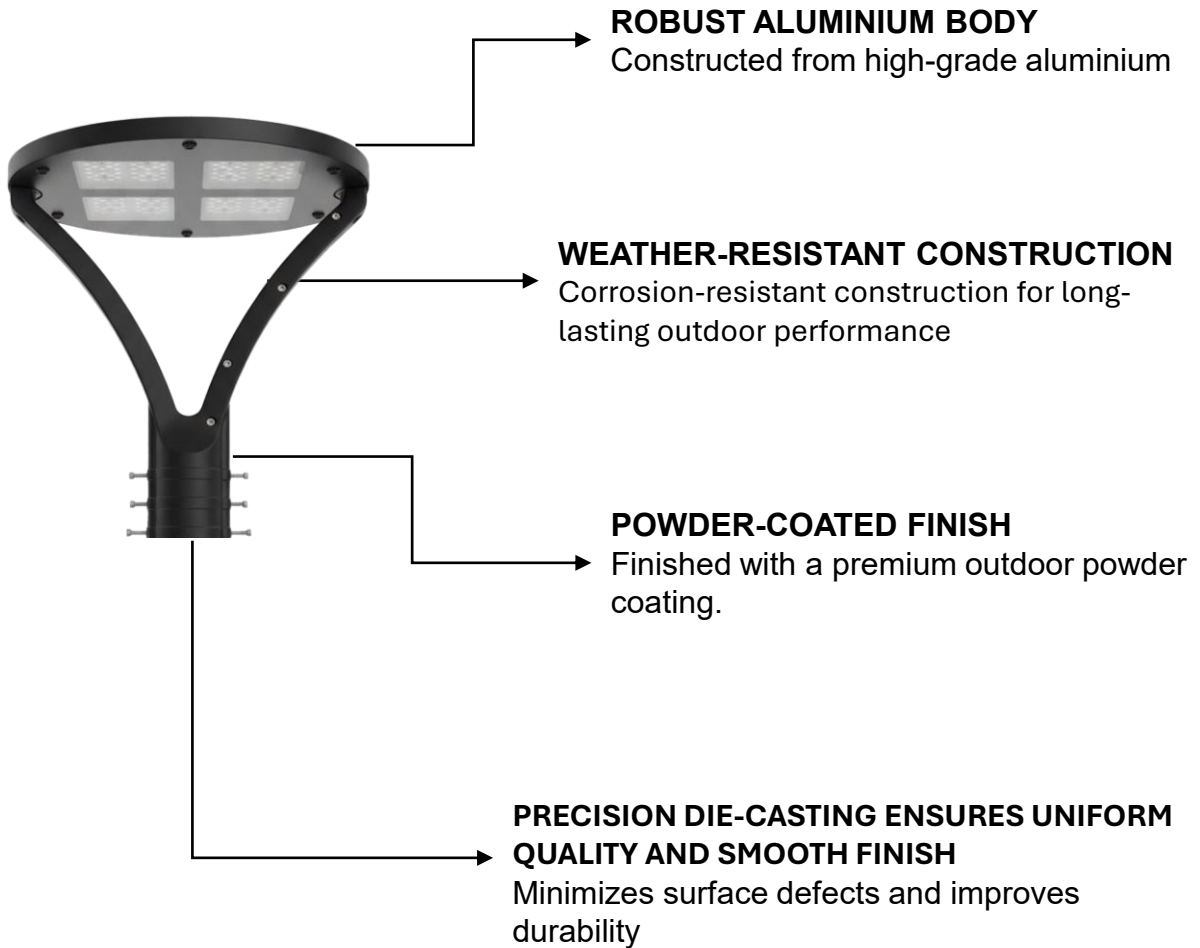

## FEATURES



Thermal Management



Corrosion Resistance



Vibration Resistance



Easy Maintenance

# ARC NEXA DC

ARCND-PTS-80W-XXXXK



## DESCRIPTION

Arc Nexa DC is a high-performance DC pole top light designed for efficient and uniform outdoor illumination. It is ideal for solar-powered, battery-based, and off-grid lighting applications. Suitable for parks and gardens, pedestrian pathways, parking areas, residential communities, and recreational spaces, where consistent and efficient lighting is essential.



## Conformity



## Compliant with



## Tested for Safety



## Insulation Class



## Protection Class



+971 65 260 706

sales-me@hansagreen.com

www.hansagreen.com



## ORDERING CODE

ARCNDC-PTS-80W-XXXXK-xx-xxxxx-XXX

PRODUCT NAME	CATEGORY	ELECTRICAL TYPE	PRODUCT FAMILY	POWER	CCT	BODY COLOUR	CONTROL OPTIONS	CONFIGURATION
ARC	N	DC	PTS	XXW	XXXXK	xx	xxxxx	XXX
ARC	NEXA	DC LIGHT	POLE TOP	UP TO 80W	2700K	BL (BLACK)	12V60-80-120-160-200	(TA) - Twin Arm (SA) - Single Arm
					3000K	SP (SPECIAL)	24V120-160-180	(ASE) - Adjustable side entry mount

Example: For the Pole top model ARC NEXA DC with a power rating of 80W, CCT 2700K, Grey body color and a height of 613 mm, dia of 402mm , Pole dia of 76mm the ordering code will be ARCNDC-PTS-80W-2700K-GR-12V80-TA

## TECHNICAL SPECIFICATION

LUMINAIRE DETAILS	
PRODUCT NAME	ARC NEXA DC
PRODUCT TYPE	LED POLE TOP LIGHT
PRODUCT CODE	ARCNDC-PTS-80W-XXXXK
MAXIMUM HOUSING POWER	UP TO 80W

HOUSING DETAILS	
BODY MATERIAL	CORROSION-RESISTANT ALUMINIUM DIE-CAST
LENS	UV-STABILIZED POLYCARBONATE (PC) LENS
OPTICAL COVER TYPE	TOUGHENED GLASS
OPTICS	SYMMETRIC
BODY COLOUR	BLACK / SPECIAL

CHIP DETAILS	
LIGHT SOURCE	SMD LEDES
AVAILABLE CCT	2700K – 3000K
MACADAM BINNING	STEP 4
CRI	≥80





## TECHNICAL SPECIFICATION

### OPTICAL DETAILS

BEAM ANGLE	94.7°
OPTICS	IES Type V (Very Short)
BUG RATING	B3-U0-G0
ULOR(Upward Light Output Ratio)	0% (U0 – Zero Uplight)

### LUMINAIRE PERFORMANCE

LUMINAIRE FLUX	8,168 lm (@ 77.77W Tested)
EFFICACY	105.03 lm/W

### ENVIRONMENTAL CONDITIONS

AMBIENT TEMPERATURE (TA)	-20°C TO +50°C
HUMIDITY	RH 10–95%

### PROTECTION & DURABILITY

IP RATING	IP66
IK RATING	IK08

### ELECTRICAL DETAILS

NOMINAL VOLTAGE	24 VDC
RATED POWER	80W
CONTROLLER TYPE	MPPT (Maximum Power Point Tracking) Solar Charge Controller





## OPTICS & PHOTOMETRIC DETAILS

Polar Plot

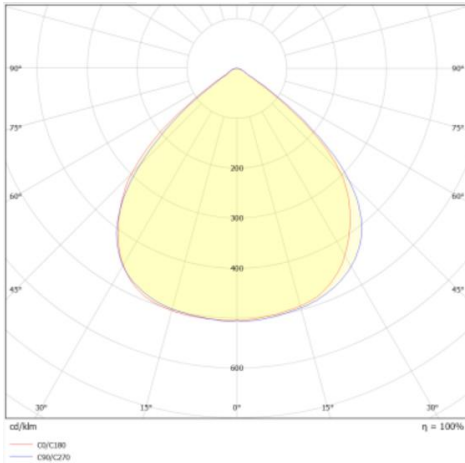

Linear Plot

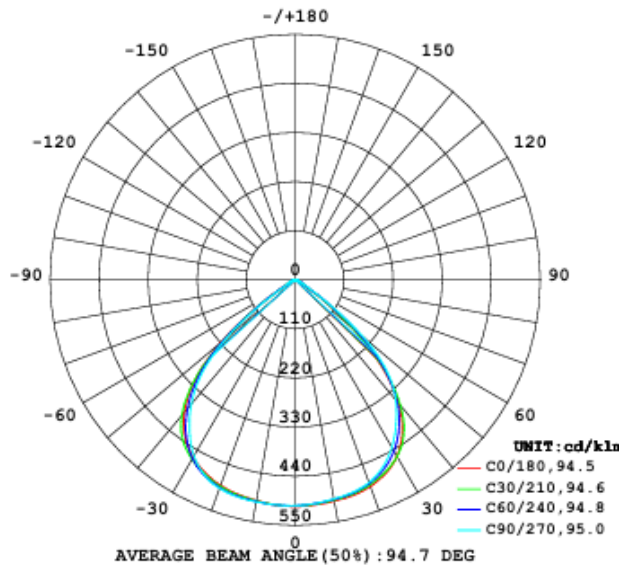
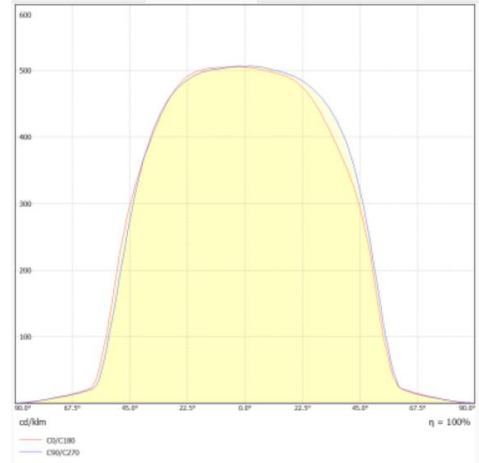

# ARC NEXA DC

ARCNDC-PTS-80W-XXXXK



## DIMENSIONAL DETAILS

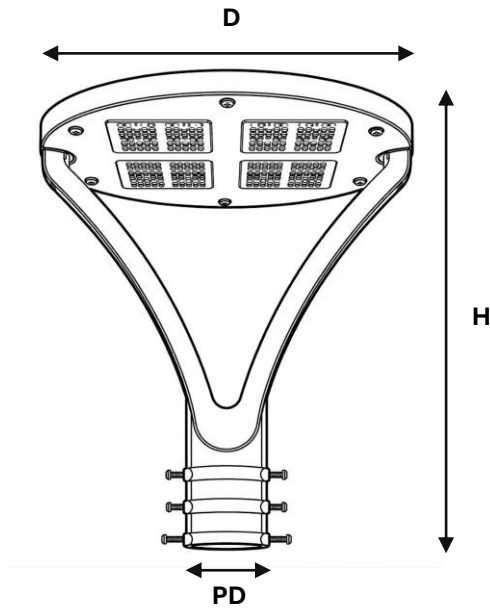

DIMENSIONS	
HEIGHT	613 mm
DIA	420 mm
POLE DIA	64 mm
WEIGHT	3.82 Kg



## GENERIC INSTALLATION STEPS

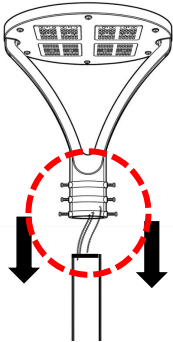

### 1. Pole Preparation

Remove the M7×20 Allen key fasteners from the mounting arm. Carefully route the supply cable through the pole and ensure it is positioned correctly to prevent damage during installation.

### 2. Fixture Mounting

Route the cable through the pole and align the luminaire with the mounting arm. Reinstall the M7×20 Allen key fasteners and tighten them securely to ensure proper fixture attachment.

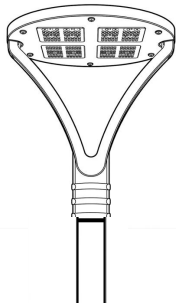
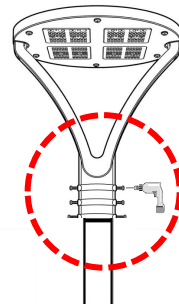

### 3. Wiring & Test

Connect the power cables securely and switch on the supply to test the luminaire operation.



Don't touch the LED



Do not dispose with normal waste



Ambient Temperature  
Ta 50°

IP66





## MOUNTING TYPE

## MOUNTING ACCESSORIES



Twin Arm post-top mount

TA - Twin Arm



Single Arm post-top mount

SA - Single Arm



Adjustable Side entry mount

ASE - Adjustable Side Entry





## TILT LIMITER

Note: DarkSky Approved when mounted in the downward position only

The tilt limiter ensures that the luminaire cannot be adjusted above 0° (horizontal).

Note- For **Adjustable Side Entry Mount** (Accessory)

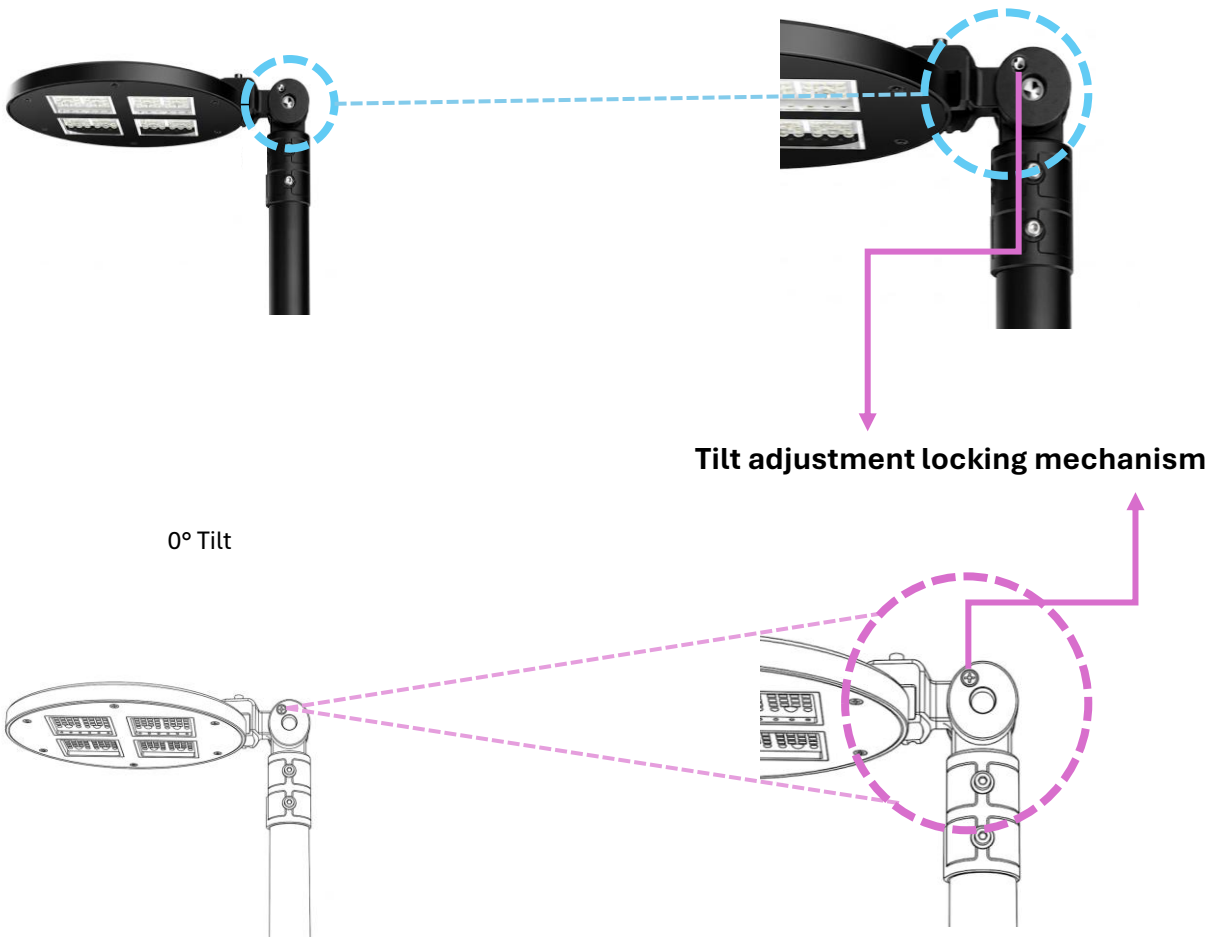

- Restricts adjustment above **0° (horizontal position)**
- Integrated **mechanical tilt-stop mechanism** for reliable angle control.
- Secure **locking mechanism** prevents unintended movement.
- Supports DarkSky-friendly lighting applications.